



K·I·T·E®

CLIENT

Installation Guide for Chromebook

September 2017



Welcome to KITE Client Software for Windows

The Kansas Interactive Testing Engine® (KITE) Client software is used by students to take tests. When running, the KITE Client software covers the full screen of the hardware, preventing students from accessing outside information during the test. This installation guide is for the people responsible for installing KITE Client software on testing machines before students take tests. The KITE Client software is available for use on either a managed or an unmanaged Chromebook. When installed, the app runs in kiosk mode.

Contents

Welcome to KITE Client Software for Windows.....	1
Structure of KITE Client Software Installation Guide	2
A Note about Graphics.....	2
Version Information.....	2
Disclaimer	2
Using KITE Client Software.....	2
Getting Help.....	2
Updating Previous Versions	3
Installing KITE Client Software	4
Installing on an Unmanaged Chromebook	4
Installing on a Managed Chromebook	6
Configuring KITE Client Software for Use with LCS	9
Pointing KITE Client Software to the LCS	9
Static IP Address – Fully Offline Mode ONLY	10
Accessing KITE Client Software.....	11
Starting KITE Client Software.....	11
Closing KITE Client Software.....	11
Troubleshooting	12
Changes to the Guide	13

Structure of KITE Client Software Installation Guide

This manual assists in the installation of KITE Client software on Chromebook® laptops.

A Note about Graphics

Every effort was made to assure the graphics in this manual match what the users will see when downloading and using the KITE Client software. Expect some slight differences depending on the operating systems used to access KITE Client software.

Version Information

This manual provides documentation for the KITE system release of September 2017.

Disclaimer

The Kansas Interactive Testing Engine®, KITE®, the KITE logo, Dynamic Learning Maps®, DLM®, the DLM logo, cPass®, and the cPass logo are trademarks of The University of Kansas. All other trademarks referenced in this guide belong to their respective owners.

Using KITE Client Software

KITE Client software is used by students to take tests.

Getting Help

Common tasks are described in this manual, but if you need additional help, call or email the Service Desk.

Hint: Check your organization's website for a toll-free number for the Service Desk.

Phone: **785-864-3537**

Email: **kite-support@ku.edu**

Updating Previous Versions

Note: KITE Client updates automatically with new releases.

Installing KITE Client Software

Note: This step is only necessary for devices that do not have the previous version of KITE Client installed.

The process of installing the KITE Client software varies somewhat depending on whether or not the Chromebook is managed or unmanaged.

Installing on an Unmanaged Chromebook

If you are using an unmanaged Chromebook, perform the following steps to install the KITE Client software.

1. Turn on the Chromebook.
 1. On the Welcome screen, select your language and keyboard.
 2. Connect to your network.
 3. Click Continue.
 4. On the Google Chrome OS Terms screen, click Accept and continue.
-

Note: Do not sign in with an account at this time. You must first enable Kiosk mode.

5. On the Sign in screen, press Ctrl+Alt+K.
-

Note: You may have to press the keys several times to reach the Enable Kiosk Mode screen.

6. Click Enable.
7. Click Ok.
8. On the Sign in screen, enter the Email and Password for the Google account that will be used with the Chromebook.
9. Click Sign In.

Hint: After you are logged in, you can close any windows that display.

10. Start the Chrome browser.
11. In the browser address bar, type `chrome://extensions`.
12. Click Enter.
13. Next to Developer mode, click the check box.

Hint: If the Add kiosk application button appears, your device is set up appropriately.

Note: If the Add kiosk application button does not appear, turn the Chromebook off and start the setup process again.

14. Click Add kiosk application.
15. Search for KITE Client.

Hint: If you cannot find the app, use the ID code:
dfbmcelmchhnfkmppcoabeplnmdljeod

Note: Do not select the option to permanently keep the device in kiosk mode.

16. Click the Add button.

Hint: KITE Client app appears in the upper box.

17. Click Done.

Installing on a Managed Chromebook

If you manage the Chromebooks at your site, you can distribute the KITE Client software to every Chromebook using the following steps.

Note: If you have difficulty finding the KITE Client app, it may help to know that the publisher is cete.us and the app ID is: dfbmcelmchhnfkmppoabepnlmdljeod

1. Log in to Google Admin console.
2. Click Device Management.

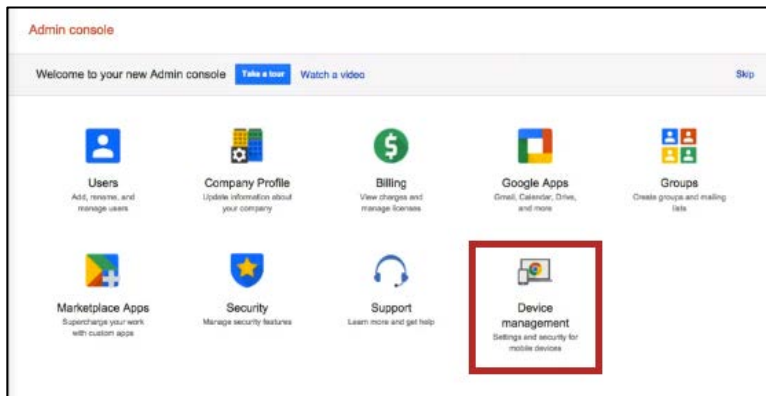

3. Under Platforms, click on Chrome.
4. On the Chrome Management screen, click Device Settings.

Hint: It may take a few moments for the settings page to load.

5. Scroll down to Kiosk Settings.

Note: If a menu is displayed under Single App Kiosk, select Allow Single App Kiosk. If no menu is displayed under Single App Kiosk, move on to the next step.

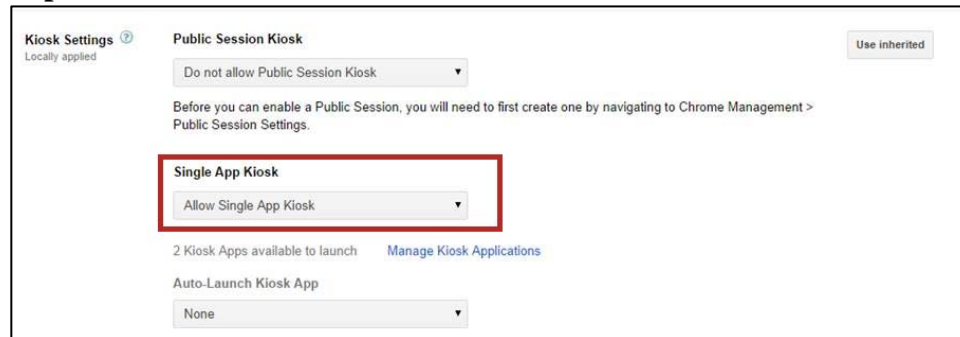

- From the Auto-Launch Kiosk App drop down, select None.

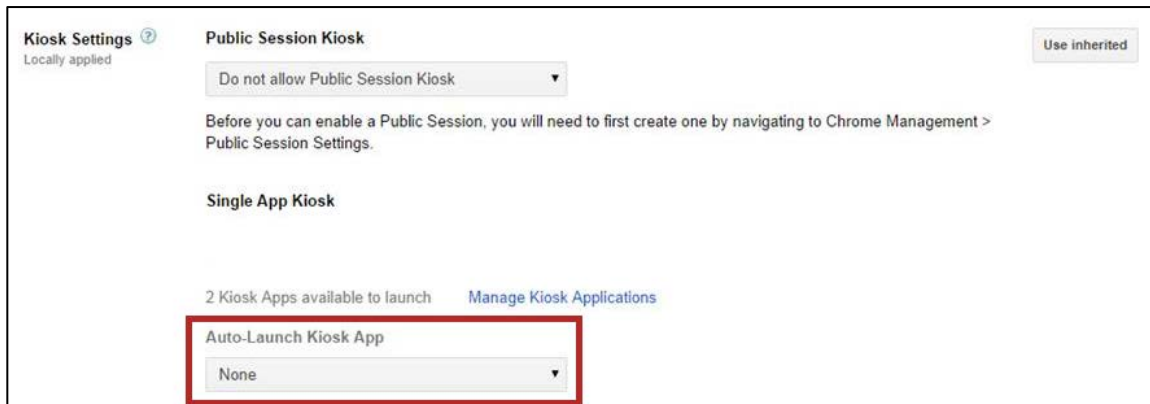

- Click Manage Kiosk Applications.

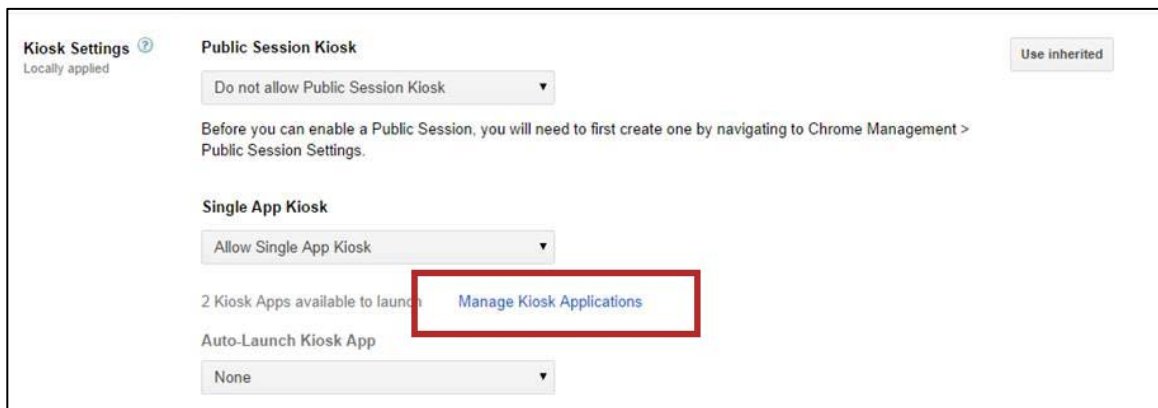

- Click Chrome Web Store.
- In the search box, type KITE.
- Press the Enter key.

Note: You must use the Enter or Return key to start the search in the web store.

11. Locate the KITE Client app in the list.
12. Click Add.

Note: After you click Add, the link changes to Added, and the KITE Client app is displayed in the list on the right side of the screen.

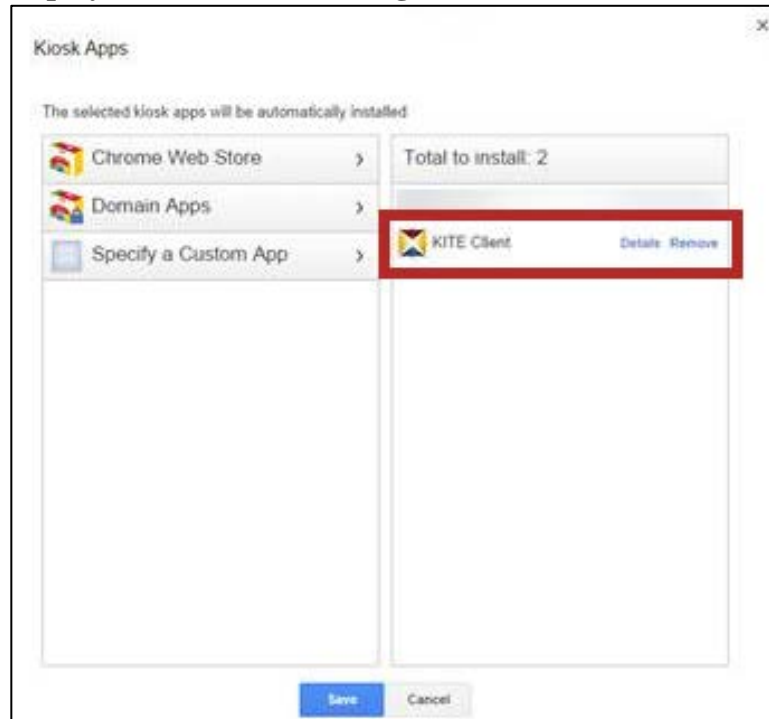

13. Click Save.
14. When the settings page displays, scroll to the bottom of the page.
15. Click Save Changes.

Note: The KITE Client software will be distributed to other managed devices on your network.

Configuring KITE Client Software for Use with LCS

Note: The LCS is not compatible with DLM® alternate assessment. If your site is participating in DLM assessments, please do not use an LCS.

Note: If your program or site does not use LCS, skip this section.

If your site uses LCS to allocate bandwidth during testing, you must set each client so that it points to the LCS.

Pointing KITE Client Software to the LCS

To configure a test machine, perform the following steps.

1. Click the settings button in the upper right side of the screen.

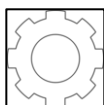

2. In the Set Host dialog box, delete the address.

A screenshot of a 'Set Host' dialog box. It features a text input field with the URL 'https://tde.cete.us/' inside. Below the input field are two buttons: 'SAVE' and 'RESET TO DEFAULT'.

3. Type the address of your LCS.

Note: Format the address as follows: **http://[IP Address]:[Port]**.

Hint: For example, with an IP Address of 10.101.0.10 and a Port of 3000, you would type `http://10.101.0.10:3000`

4. Click Save.

Static IP Address – Fully Offline Mode ONLY

Note: The following procedure is only required if you will be testing using the LCS in fully offline mode. If you are unsure, please contact your organization for guidance.

If you are using LCS in fully offline mode, you must configure each KITE Client machine to use a static IPv4 address during testing. To configure the KITE Client software, perform the following steps.

5. Open your network connection settings.
6. On the Network tab, clear the Configure automatically checkbox.
7. In the IP Address field, type the IP address of your LCS.

Hint: You do not need to enter the port number.

8. In the Subnet Mask field, type:

255 . 255 . 255 . 0

9. Save the settings.

Accessing KITE Client Software

For more information about using the KITE Client software, refer to the Educator’s Guide to KITE Client Software.

Starting KITE Client Software

To start the KITE Client software, perform the following steps.

1. Sign out of the Chromebook.

Note: The student must be signed out of the Chromebook to see the “Apps” choice next to Shut Down in the lower left.

2. Select the “Apps” button at the bottom of the sign-in screen.
3. Select the KITE Client app.

Note: If the KITEClient app has not automatically updated, the following message will be displayed. The app will need to be deleted and reinstalled for the latest version.

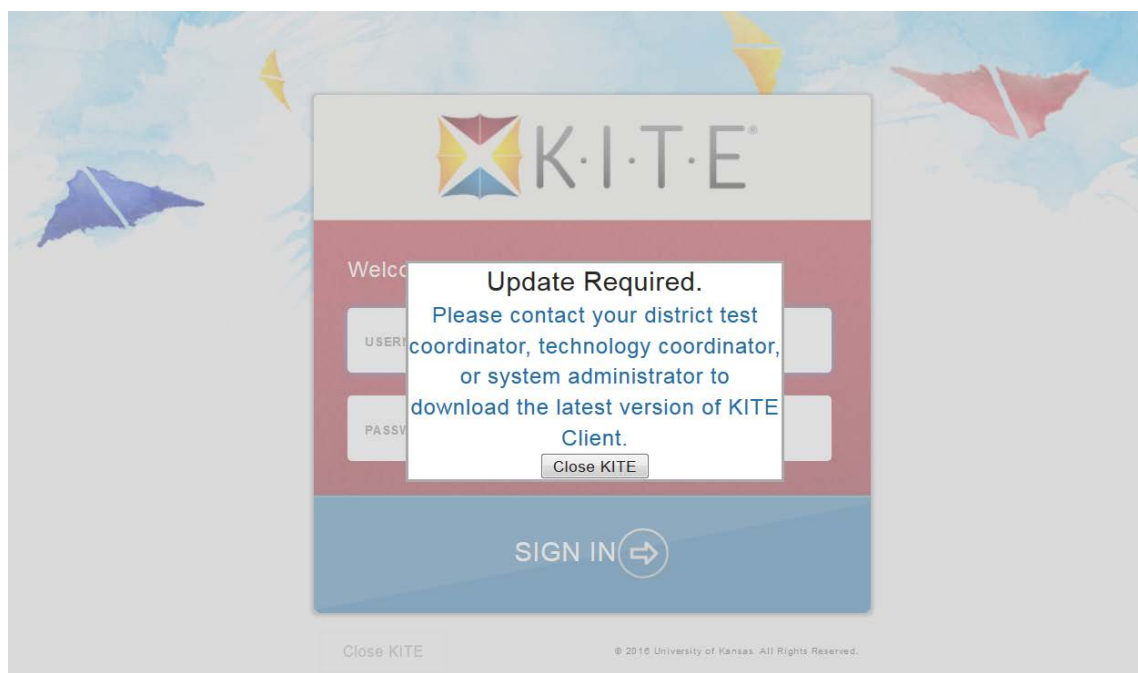

Closing KITE Client Software

To close the KITE Client software, restart the Chromebook.

Troubleshooting

If you encounter any errors while using the KITE Client software, you can always contact the service desk (contact information is on the first page of this guide). Some common issues and their solutions are below.

During testing, ChromeVox starts reading the text aloud.

ChromeVox is the “spoken feedback” or text-to-speech feature included with Chrome. To turn off ChromeVox, type Ctrl+Alt+Z.

The screen rotated 90 degrees.

Type Ctrl+Shift+Rotate to return the screen to normal orientation.

Changes to the Guide

The following table lists the changes made to this guide since the last major release of the documentation.

Note: The Page column indicates the page number of the current document where the change appears.

Change Logged	Page	Description of Change
9/1/2017	All	Major document overhaul.